



logitech G435 Wireless Gaming Headset User Guide

[Home](#) » [Logitech](#) » logitech G435 Wireless Gaming Headset User Guide 



SETUP GUIDE

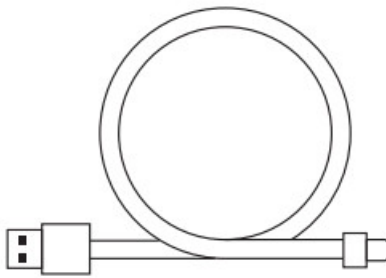

Contents [\[hide](#)

- [1 LIGHTSPEED CONNECTION](#)
- [2 BLUETOOTH CONNECTION](#)
- [3 SWITCH BETWEEN LIGHTSPEED AND BLUETOOTH](#)
- [4 POWER ON AND OFF](#)
- [5 MUTE / UNMUTE AND MAX VOLUME](#)
- [6 BATTERY CHECK](#)
- [7 SIDETONE](#)
- [8 SPARE PARTS](#)
- [9 RECYCLING](#)
- [10 QUESTIONS?](#)
- [11 BATTERY REMOVAL](#)
- [12 File Downloads](#)
- [13 References](#)
- [14 Related Manuals](#)

LIGHTSPEED CONNECTION

Connect to your PC, Mac, PlayStation 5, or 4 with LIGHTSPEED Wireless Technology
– Insert the receiver into the USB port of your device

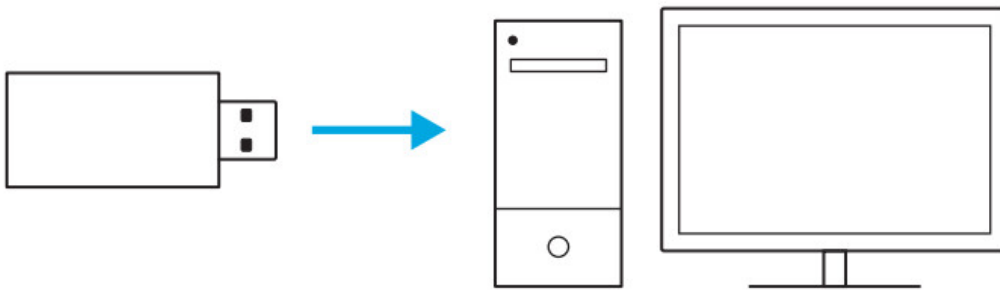

minimum of 1.5 sec

– Press the Power button for a

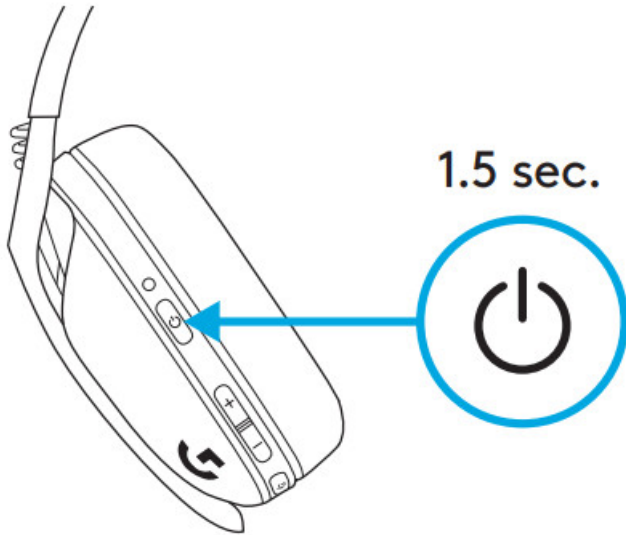

– The LED turns cyan once connected

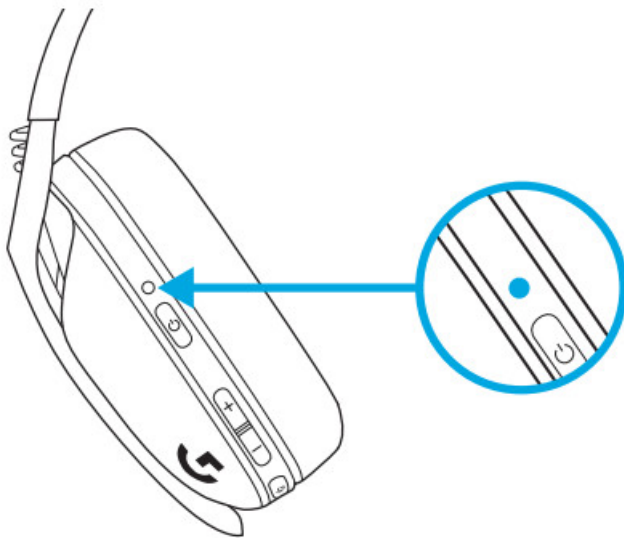

BLUETOOTH CONNECTION

– Press 3 seconds or longer of the Power and Mute button

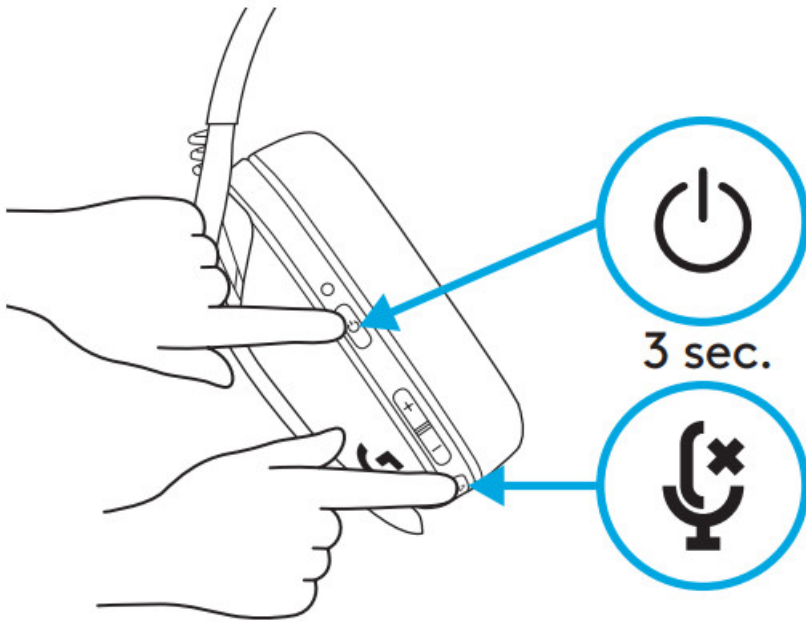

– LED will flash blue as it enters pairing mode

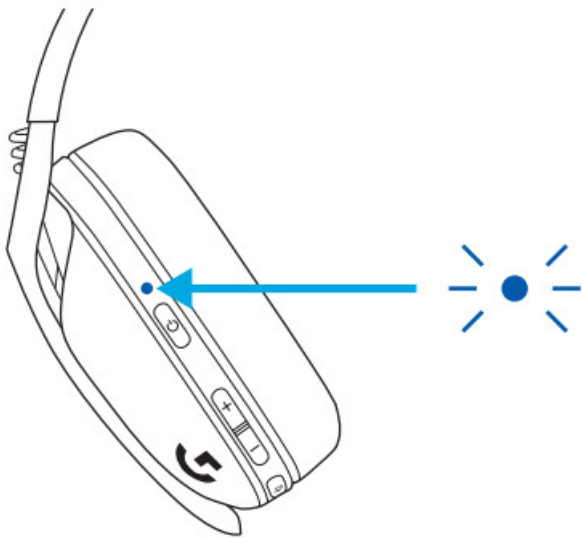

– Connect to your preferred device

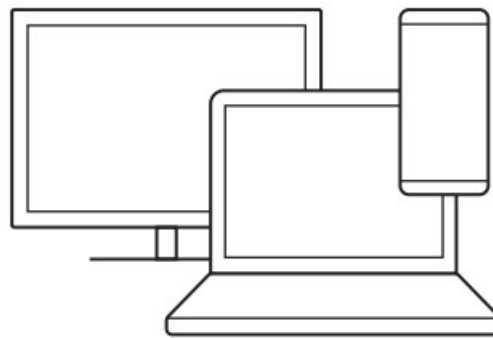

– G435 can connect to a single

Bluetooth device at a time

SWITCH BETWEEN LIGHTSPEED AND BLUETOOTH

– Press 3 seconds or longer of the Mute button

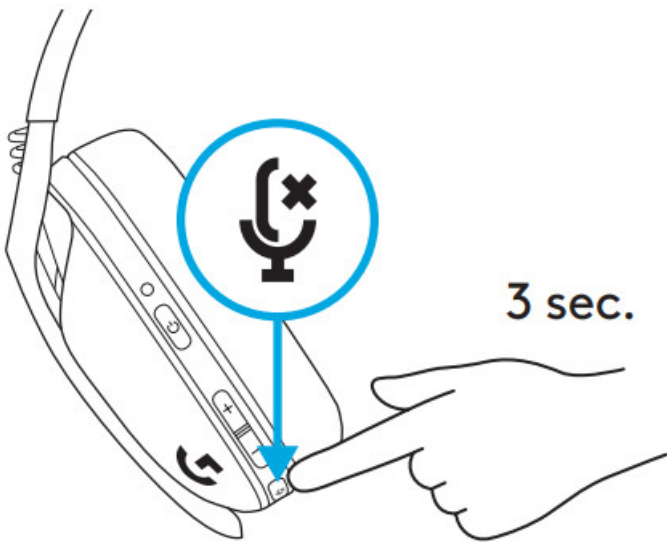

3 sec.

– Switch to LIGHTSPEED, LED will light cyan for 5 seconds

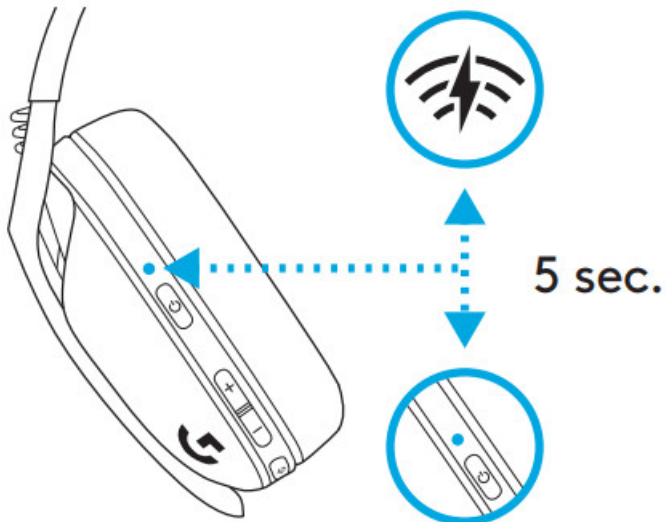

5 sec.

– Switch to Bluetooth, LED will light blue for 5 seconds

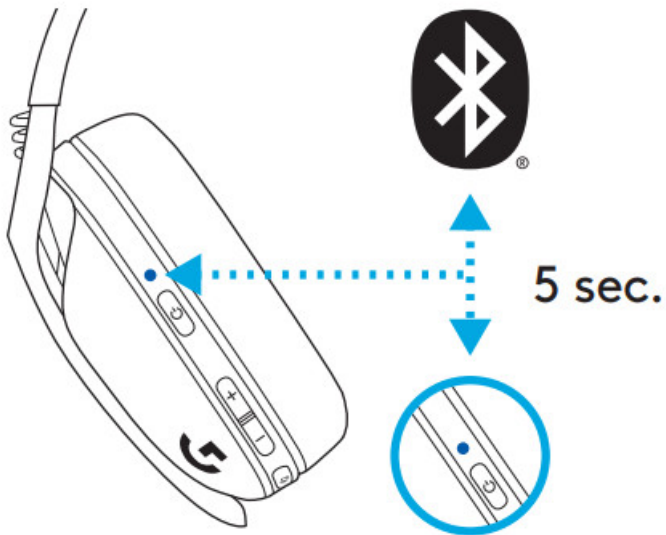

5 sec.

POWER ON AND OFF

Power ON

– Press the Power button for 1 5 seconds when the headset is OFF

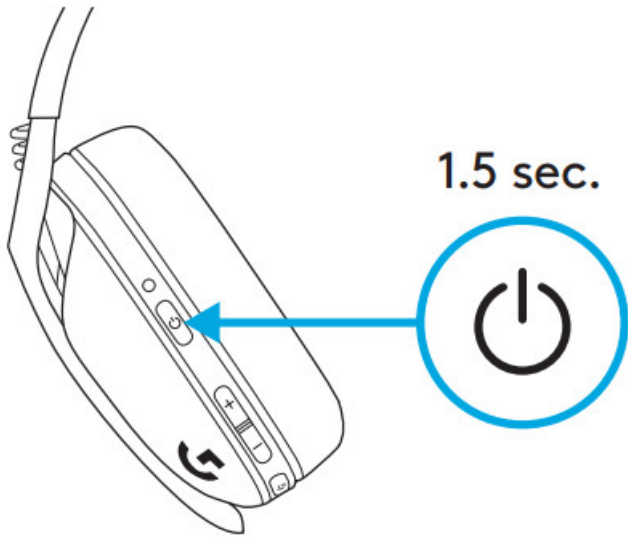

Power OFF

- Press the Power button for 3 seconds when the headset is ON

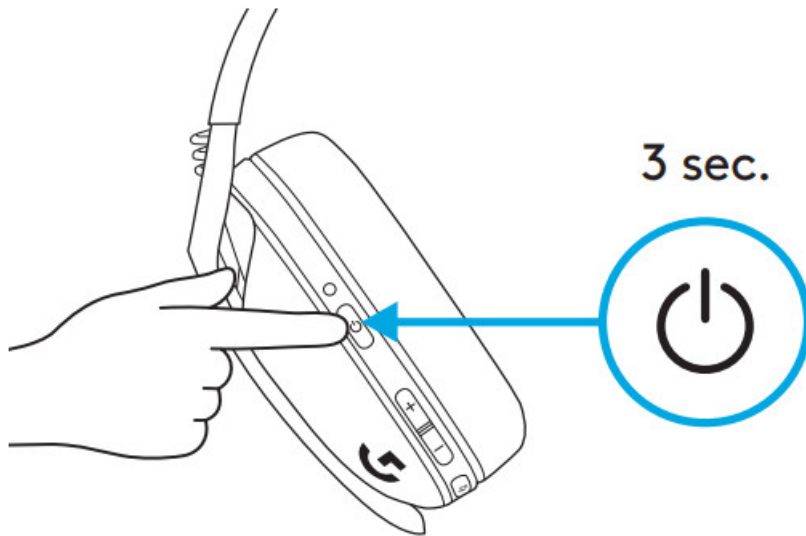

Auto Shutoff

- After 30 minutes of inactivity

MUTE / UNMUTE AND MAX VOLUME

MUTE / UNMUTE microphone

- Short press on the Mute button

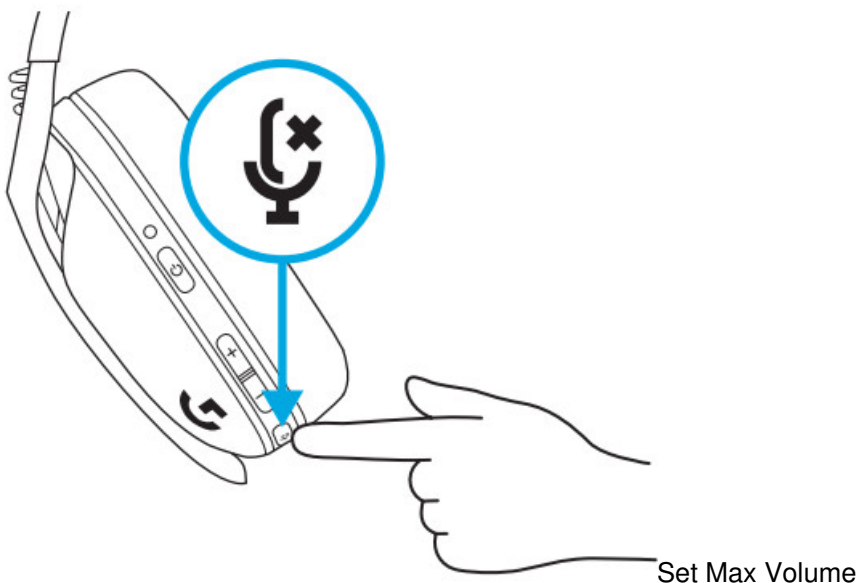

- Set to 100 dB
- Press 3 seconds or longer Mute button + Volume UP
- LED will flash orange 3 times

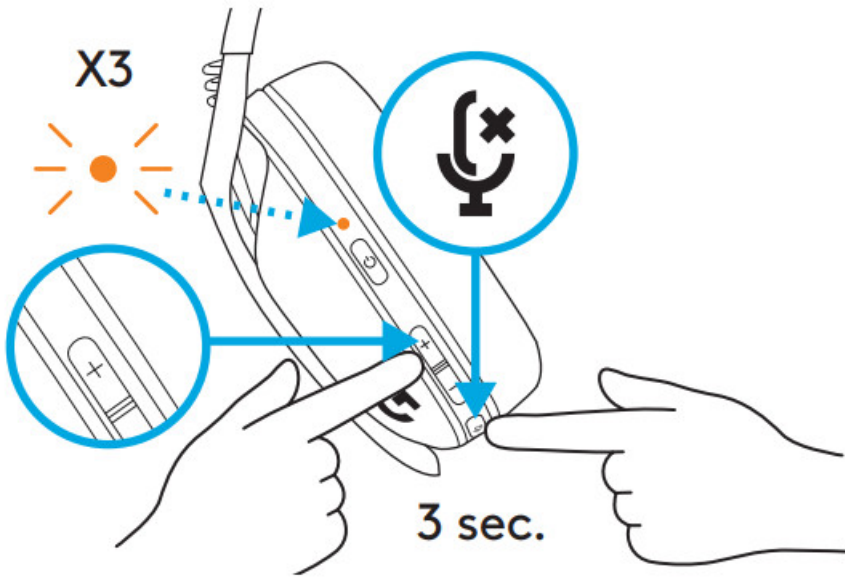

– Set to 85 dB

- Press 3 seconds or longer Mute button + Volume DOWN
- LED will turn solid orange for 5 seconds

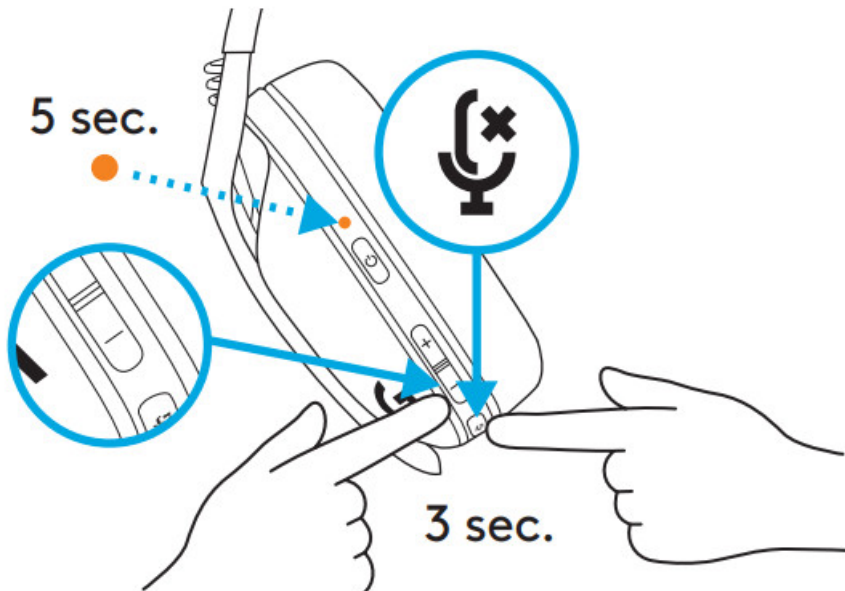

BATTERY CHECK

- Single press the Power button, when the headset is ON
- Battery 31% to 100% the LED will show green for 5 seconds

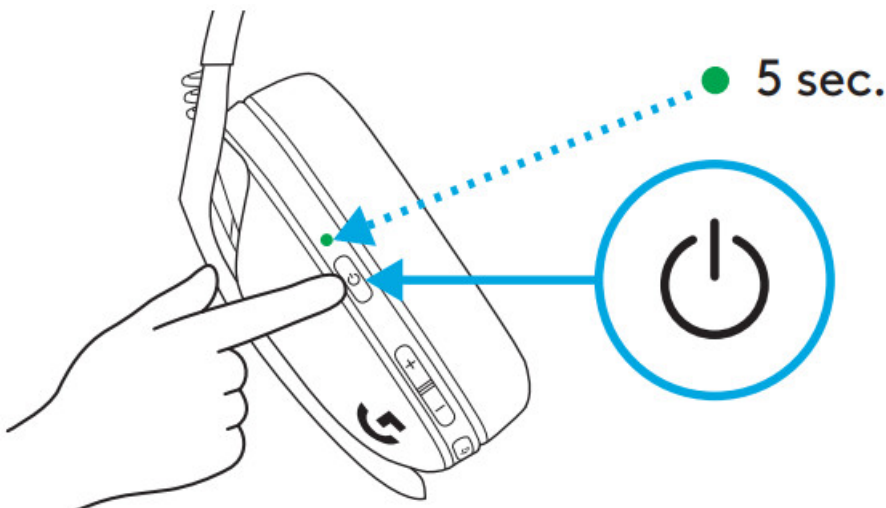

– Battery 15% to 30% the LED will show

red for 5 seconds

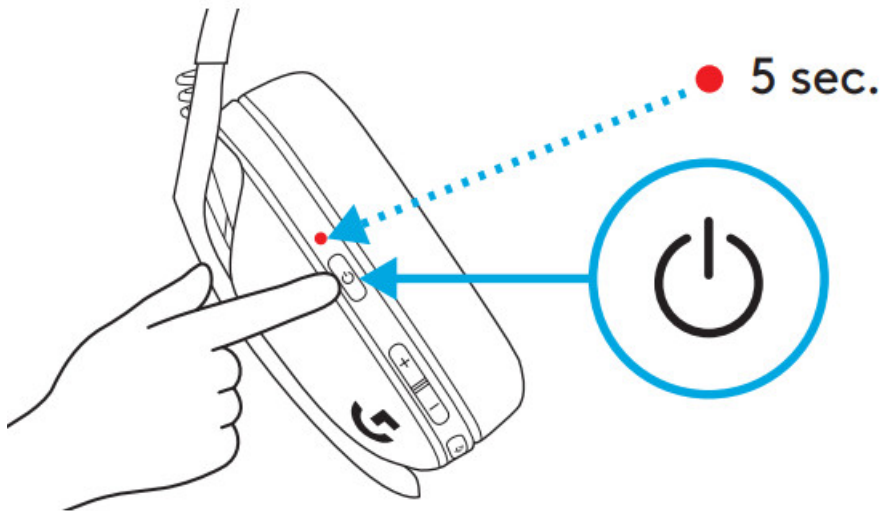

– Battery <15% the LED will flash red

for 5 seconds

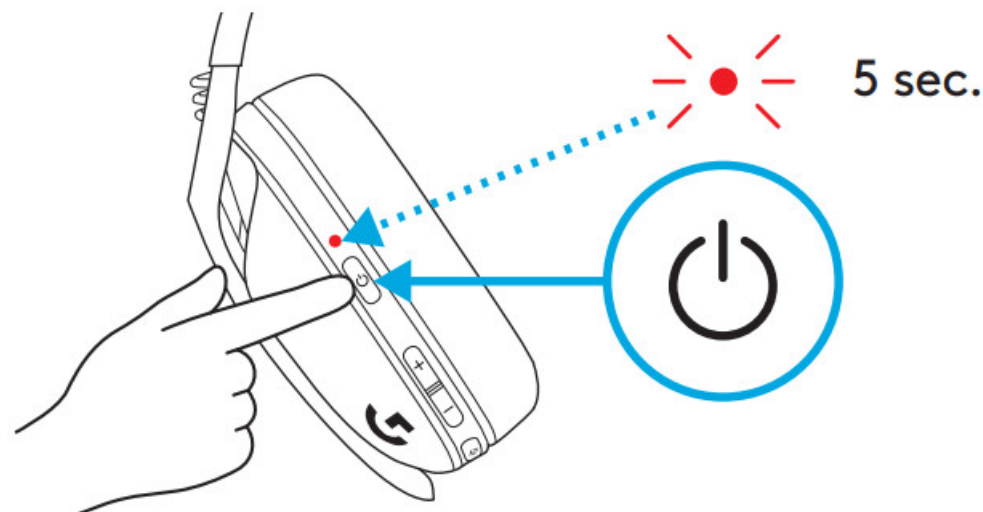

SIDETONE

Sidetone lets you hear your voice while communicating with other people, It mirrors the experience of talking on a phone and allows you to adjust your speaking volume to a proper level

- Enable Sidetone
- Double press the Mute button and the LED will flash twice in orange

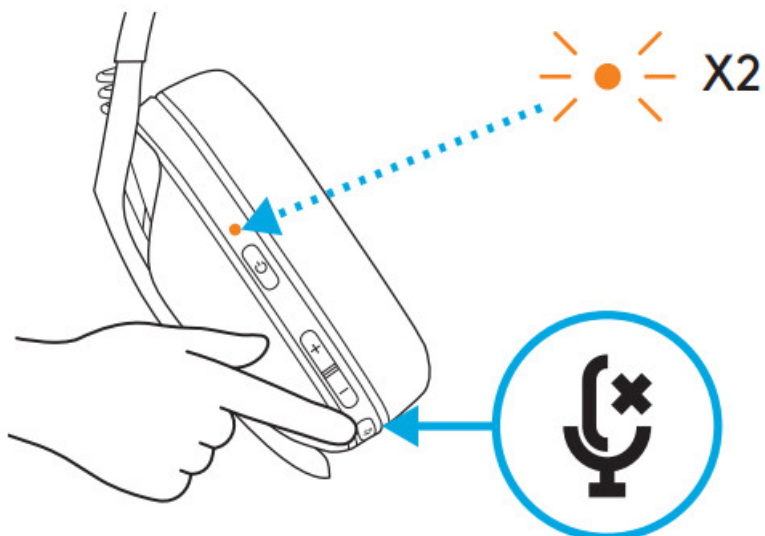

– Disable Sidetone

- Double press the Mute button and the LED will flash once in orange

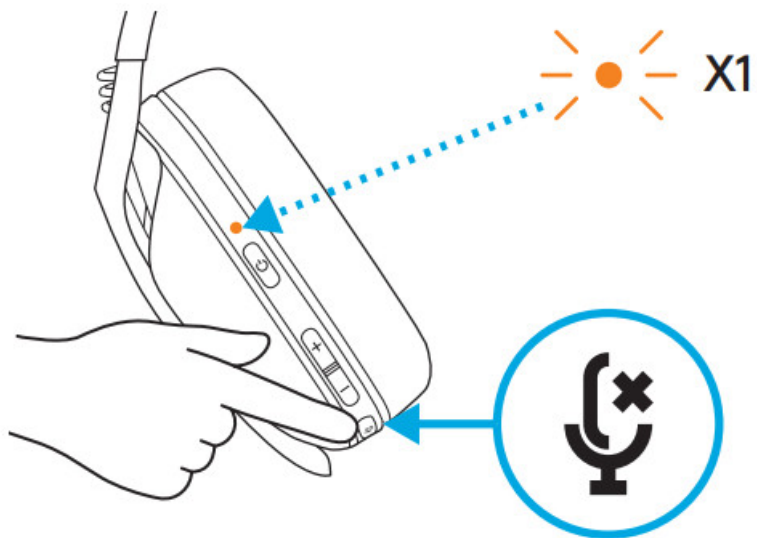

– Adjust Sidetone

– UP = Single press Mute button + Volume UP

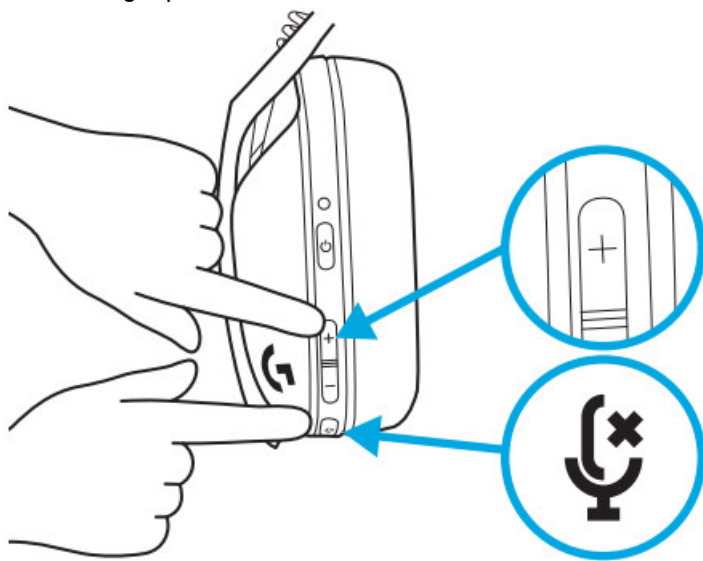

– DOWN = Single press Mute button + Volume DOWN

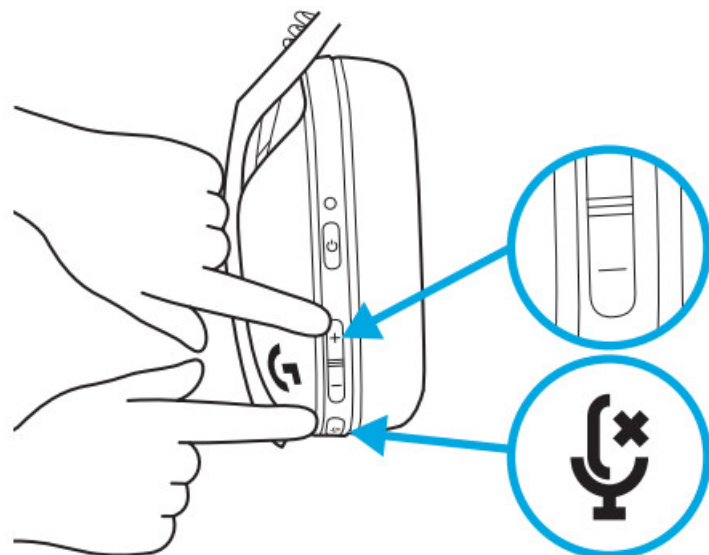

SPARE PARTS

- Earpads
- Wireless USB Receiver
- Charging Cable

RECYCLING

We encourage you to resell or donate working products. Otherwise, batteries, electronic and electrical equipment should not be disposed of with household waste. Wherever possible, they should be segregated and brought to an appropriate collection point to enable recycling and avoid potential impacts on the environment and human health. For more information, contact your local authorities or place of purchase, or visit www.logitech.com/recycling

QUESTIONS?

logitech.com/support/G435

BATTERY REMOVAL

1

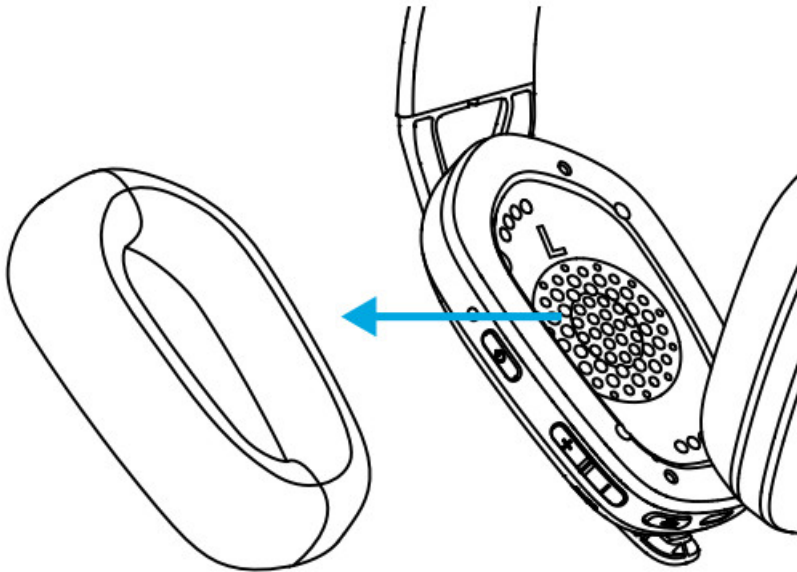

2

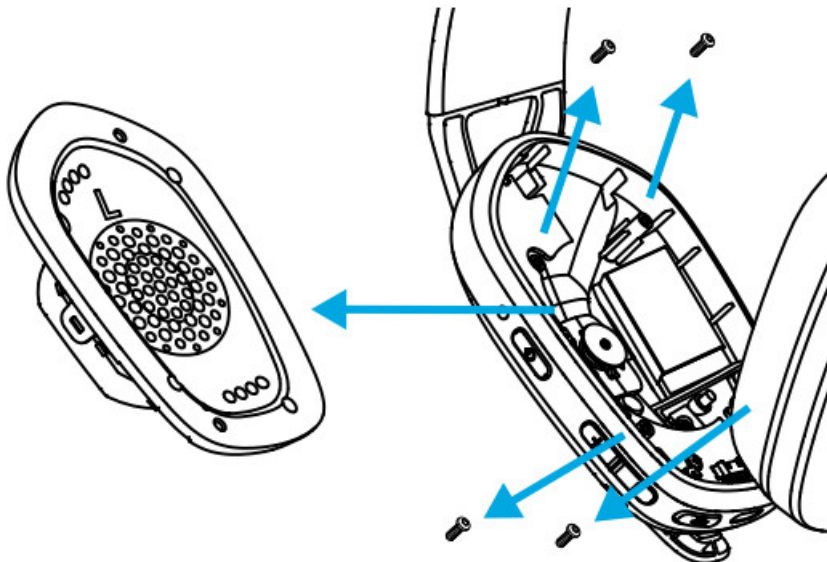

3

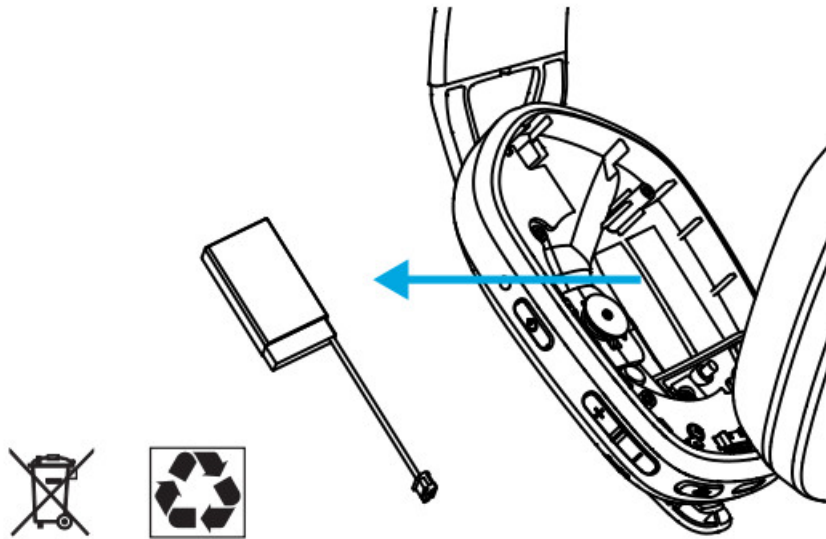

©2021 Logitech Logitech, Logitech G, Logi, and their respective logos are trademarks or registered trademarks of Logitech Europe S A and/or its affiliates in the US and other countries All other trademarks are the property of their respective owners Logitech assumes no responsibility for any errors that may appear in this manual Information contained herein is subject to change without notice
WEB-621-002087 002

File Downloads



logitech User Guide [Download](#) [optimized]
G435, Wireless Gaming Headset [Download](#)

References

- [logi Global Recycling Program for Ewaste and Batteries - Logitech](#)

Related Manuals

1. [logitech Pro X Wireless LightSpeed Gaming Headset User Guide](#) logitech Pro X Wireless LightSpeed Gaming Headset A Quick Look...
2. [logitech Wireless Gaming Headset Instructions](#) logitech Wireless Gaming Headset SETUP INSTRUCTIONS Insert the mic boom...
3. [logitech Gaming Headset G PRO User Guide](#) logitech Gaming Headset G PRO User Guide PC...
4. [logitech Headset Wireless User Guide](#) WIRELESS HEADSET H600 Complete Setup Guide KNOW YOUR PRODUCT ...
5. [logitech Wireless Gaming Mouse User Guide](#) logitech Wireless Gaming Mouse SETUP INSTRUCTIONS A wireless

receiver attached...

6. [logitech Wireless Headset H600 User Guide](#) logitech Wireless Headset H600 User Guide KNOW YOUR PRODUCT...